

DO NOT SCALE

NOTES:

- 1. GENERAL ARRANGEMENT IS BASED ON BDP LANDSCAPE MASTERPLAN REVISION A DATED 7 MAY 2019.
- 2. BDP TO CO-ORDINATE THE ALIGNMENT OF INTERPATH DRAINAGE WITH FEATURE PAVING AND PLANTERS.
- 3. BDP TO CONFIRM THE EXTENT OF WORKS. ADDITIONAL TOPOGRAPHICAL SURVEY MAY BE REQUIRED EAST OF PICCADILLY TO TIE IN SIDE ROADS.
- 4. DEVELOPERS TO CONFIRM EXTENT OF DROP KERB REQUIRED FOR VEHICLE ACCESS.

KEY:

PROPOSED FEATURES:

- PROPOSED FOOTWAY
- PROPOSED RAISED BLOCK PAVED SPEED TABLE
- PROPOSED LANDSCAPING
- PROPOSED KERB (100mm UPSTAND)
- PROPOSED BULLNOSED KERB (MAXIMUM 25mm UPSTAND)
- PROPOSED BULLNOSED KERB (MAXIMUM 6mm UPSTAND)
- PROPOSED KERB TAPER
- PROPOSED SQUARE CHANNEL
- PROPOSED INTERPATH DRAINAGE
- PROPOSED SPEED CHECK KERB
- PROPOSED TACTILE PAVERS

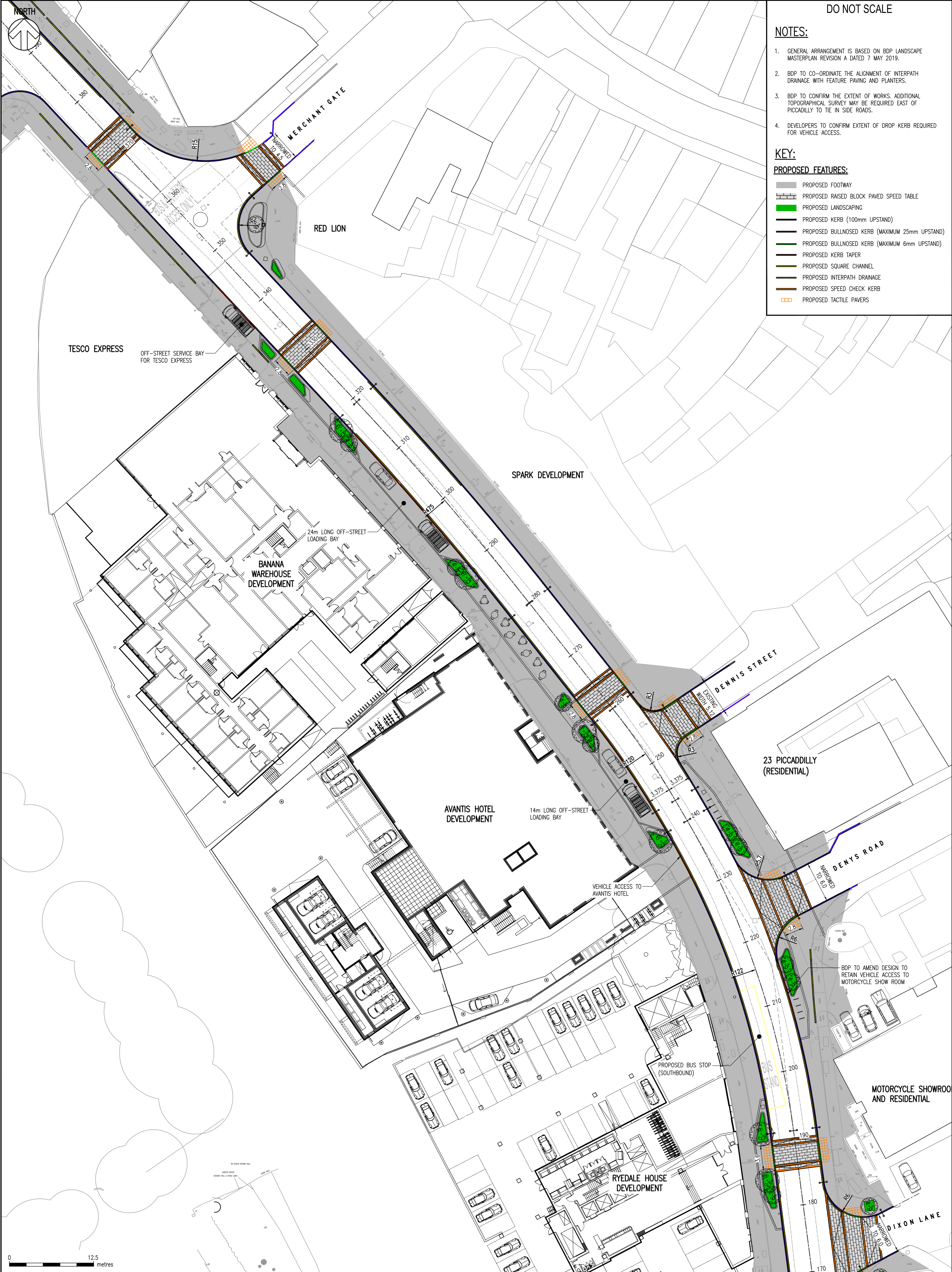

File name: \\UK-WSPGROUP\CENTRAL\DATA\PROJECTS\70034291\PICCADILLY\DEVELOPMENT\INFRASTRUCTURE\DRAWINGS\AUTOCAD\70034291-PIC-GA-102.dwg, printed on 12 August 2019 11:07:45, by Douglas, Vicky

P01	12/06/2019	VD	FIRST ISSUE	CC	CC
REV	DATE	BY	DESCRIPTION	CHK	APP
DRAWING STATUS: S1- FOR COORDINATION					

wsp

Three White Rose Office Park
Millshaw Park Lane
Leeds
LS11 0DL, UK

T+ 44 (0) 113 395 6200
F+ 44 (0) 113 395 6201
wsp.com

CLIENT:	BDP
ARCHITECT:	BDP

PROJECT:	PICCADILLY, YORK
TITLE:	GENERAL ARRANGEMENT PICCADILLY - NORTH

SCALE @ A1:	1:250	CHECKED:	CC	APPROVED:	CC	
PROJECT No:	70034291	DESIGNED:	VD	DRAWN:	VD	
DRAWING No: 70034291-PIC-GA-102					DATE:	August 19
REV: P01					© WSP UK Ltd	